

# BoxSizer®

## BX-F600-L | Fixed footprint with glue lid closure

### Standard technical specifications

**Speed:** Up to 10 boxes per minute (dependent on box height)\*\*

**Box footprint:** Fixed

**Closure:** Cut/crimp/fold/glue/lid†

**Min box footprint:** 320mm x 250mm (12.6" x 9.8")\*

**Max box footprint:** 750mm x 500mm (19.7" x 29.5")

**Typical max cut length:** 410mm (16.1") (dependant on box height and width)

**Typical infeed/outfeed height:** 700mm (27.5")

**Sample power consumption UK:** 21Kw, 30A/Ph, 50Hz, 400V, 3 Phase, N&E

**Sample power consumption USA:** 21Kw, 30A/Ph, 60Hz, 480V, 3 Phase, N&E

**Air consumption:** Average 25 cfm @ 80-100 psi  
Peak 42.5 cfm @ 80-100 psi @ 15 cycles/min

**Net weight:** 3200Kg (7115lbs)

**Specific components:** Rockwell control system

Typical machine floorplan ref.: LS-27486

Touchscreen operator interface with management information and remote diagnostics

Emergency stops and safety circuitry, fully CE marked

Mild steel powder coated main frame

Low maintenance servo drives used for precision motion control and remote diagnosis

### Box specifications

**Box styles:** HSC or FEFCO 0200/0300/0301. Preferred 0200/HSC.

**Materials:** B, C and E fluted corrugate of various grades typical, but not limited.

\*Minimum box size will be half of largest box dimensions being run. \*\*Speeds are typical, based on standard specification and is dependent on pitch and box height, actual production speed may increase/decrease from stated, bespoke options available. †Additional closure options available including: glue and tape, lidding, strapping and bagging. Note: Recommended maximum weight for loaded box 25Kg (55lbs).

For more information, contact: WestRock Automated Packaging Systems  
Phone: +44.0.1502.713777 • E-mail: [aps.uk@westrock.com](mailto:aps.uk@westrock.com) • [www.linkxpackaging.com](http://www.linkxpackaging.com)

### Options

A range of models are available with different closure options, including: tape, lidding and strapping.

### Typical box infeed/outfeed

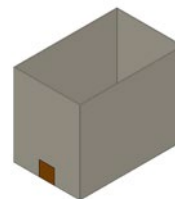

Typical box in

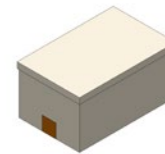

Typical box out cut/  
crimp/fold/glue/lid  
reduced volume 1



Typical box out cut/  
crimp/fold/glue/lid  
reduced volume 2

